



Thank you for choosing SABA quality. This product has been developed by our team of professional and according to European regulations. In order to get the most out of your new appliance, we recommend that you read this instruction manual carefully and keep it for future reference.

TABLE OF CONTENTS

GB

Safety instructions36

Installation40

Operations45

Maintenances55

Trouble shooting60

Disposal of old electrical appliances64

Safety instructions

- This appliance is intended to be used in household and similar applications such as:
 - staff kitchen areas in shops, offices and other working environments;
 - farm houses;
 - by clients in hotels, motels and other residential type environments;
 - bed and breakfast type environments.
- The appliances shall be connected to the water mains using new hose-sets supplied with the appliance, old hose-sets should not be reused.
- The ventilation openings must not be obstructed by a carpet.
- This appliance can be used by children aged from 8 years and above and persons with reduced physical, sensory or mental capabilities or lack of experience and knowledge if they have been given supervision or instruction concerning use of the appliance in a safe way and understand the hazards involved. Children shall not play with the appliance. Cleaning and user maintenance shall not be made by children without supervision.
- Children of less than 3 years should be kept away unless continuously supervised.
- If the supply cord is damaged, it must be replaced by the manufacturer, its service agent or similarly qualified persons in order to avoid a hazard.

- Regarding the instructions for installation and electric connection of the appliance, refer to the below paragraph of the manual.
- CAUTION: Do not connect to the hot water supply.
- The maximum dry laundry weight is 8 kilograms.
- Maximum inlet water pressure: 1 MPa
- Minimum inlet water pressure: 0.05 MPa

⚠ Caution!

Installing the product!

- This washing machine is for indoor use only.
- It isn't intended to be built-in using.
- The openings must not be obstructed by a carpet.
- Washing machine shall not be installed in bath room or very wet rooms as well as in the rooms with explosive or caustic gases.
- The washing machine with single inlet valve only can be connected to the cold water supply. The product with double inlet valves should be correctly connected to the hot water and cold water supply.
- Plug must be accessible after installation.
- Remove all packages and transport bolts before using the appliance. Otherwise, serious damage may result.

Risk of damaging appliance!

- Your product is only for home use and is only designed for the textiles suitable for machine washing.
- Do not climb up and sit on top cover of the machine.

- Do not lean against machine door.

Cautions during Handling Machine:

1. Transport bolts shall be reinstalled to the machine by a specialized person.
2. The accumulated water shall be drained out of the machine.
3. Handle the machine carefully. Never hold each protruded part on the machine while lifting. Machine door can not be used as the handle during the conveyance.
4. This appliance is heavy. Transport with care.
 - Please do not close the door with excessive forces. If it is found difficult to close the door, please check if the clothes are put in or distributed well.
 - It is forbidden to wash carpets.

Operating the appliance!

- Before washing the clothes at first time, the product shall be operated in one round of the whole procedures without the clothes inside.
- Flammable and explosive or toxic solvents are forbidden. Gasoline and alcohol etc. Shall not be used as detergents. Please only select the detergents suitable for machine washing, especially for drum.
- Make sure that all pockets are emptied. Sharp and rigid items such as coin, brooch, nail, screw or stone etc. may cause serious damages to this machine.

- Please check whether the water inside the drum has been drained before opening its door. Please do not open the door if there is any water visible.
- Be careful of burning when the product drains hot washing water.
- Never refill the water by hand during washing.
- After the program is completed, Please wait for two minutes to open the door.

Installation

Product Description

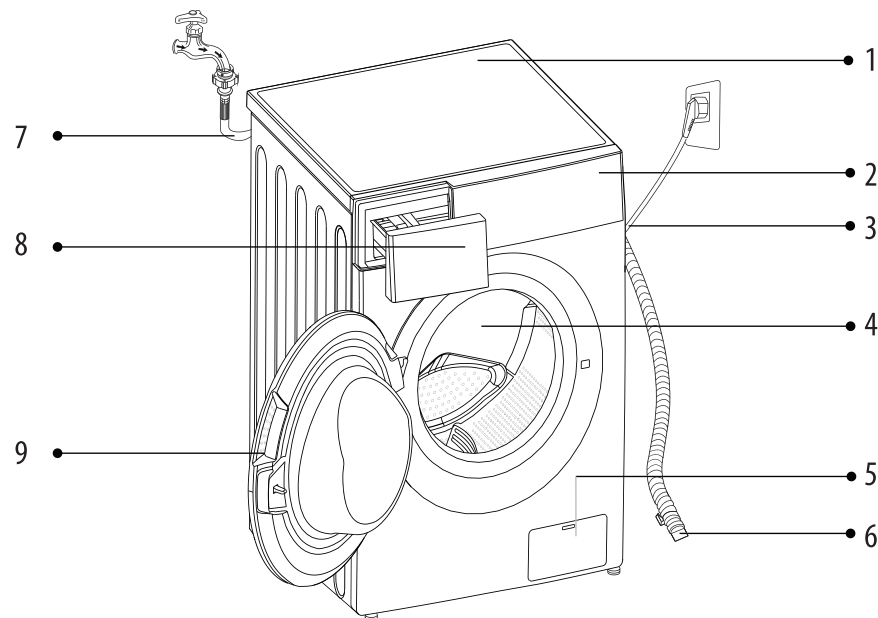

- | | |
|----------------------|------------------------|
| 1. Top cover | 6. Drain hose |
| 2. Control panel | 7. Water supply hose |
| 3. Power supply cord | 8. Detergent dispenser |
| 4. Drum | 9. Door |
| 5. Service filter | |

Note!

- The product line chart is for reference only, please refer to real product as standard.

Accessories

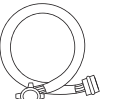
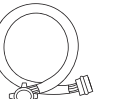
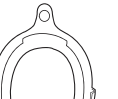
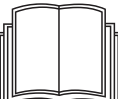
				
Transport hole plug	Supply hose cold water	Supply hose hot water (optional)	Drain hose support (optional)	Owner's manual

Installation area

Warning!

- Stability is important to prevent the product from wandering!
- Make sure that the product should not stand on the power cord.

Before installing the machine, the location characterized as follows shall be selected:

- Rigid, dry, and level surface
- Avoid direct sunlight
- Sufficient ventilation
- Room temperature is above 0°C
- Keep far away from the heat resources such as coal or gas.

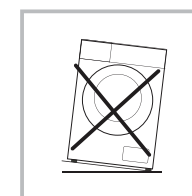
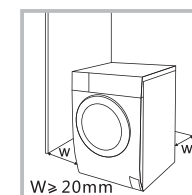

Unpacking the washing machine

⚠ Warning!

- Packaging material (e.g. Films, Styrofoam) can be dangerous for children.
- There is a risk of suffocation! Keep all packaging well away from children.

1. Remove the cardboard box and styrofoam packing.
2. Lift the washing machine and remove the base packing. Make sure the small triangle foam is removed with the bottom one together. If not, lay the unit down with side surface then remove the small foam from the unit bottom manually.
3. Remove the tape securing the power supply cord and drain hose.
4. Remove the inlet hose from the drum.

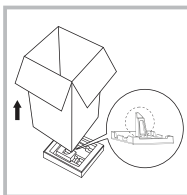

Remove transport bolts

⚠ Warning!

- You must remove the transport bolts from the backside before using the product.
- You'll need the transport bolts again if you move the product, so make sure you keep them in a safe place.

Please take the following steps to remove the bolts:

1. Loosen 4 bolts with spanner and then remove them.

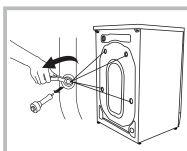

2. Stop the holes with transport hole plugs.
3. Keep the transport bolts properly for future use.

Levelling the washing machine!

⚠ Warning!

- The lock nuts on all four feet must be screwed tightly against the housing.

1. Check if the legs are closely attached to the cabinet. If not, please turn them to their original positions tighten the nuts.
2. Loosen the lock nut turn the feet until it closely contacts with the floor.
3. Adjust the legs and lock them with a spanner, make sure the machine is steady.

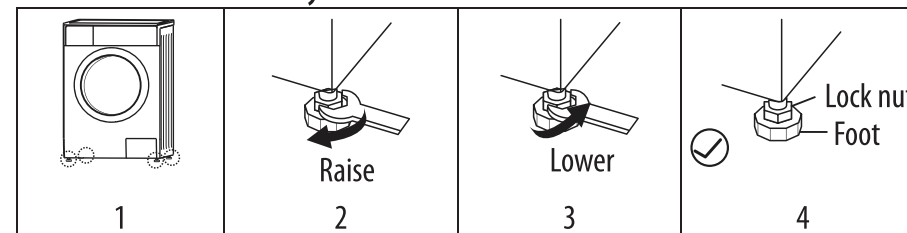

Connect Water Supply Hose

⚠ Warning!

- To prevent leakage or water damage, follow the instructions in this chapter!
- Do not kink, crush, modify or sever water inlet hose.
- For the model equips hot valve, connect it to hot water tap with hot water supply hose. Energy consumption will decrease automatically for some program.

Connection between screw tap and inlet hose.

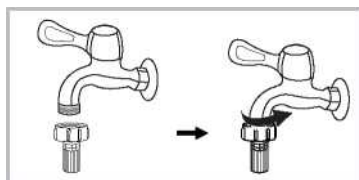

Tap with threads and inlet hose

Connect the other end of inlet pipe to the inlet valve at the backside of product and fasten the pipe tightly clockwise.



GB

Drain Hose

⚠ Warning!

- Do not kink or protract the drain hose.
- Position drain hose properly, otherwise damage might result of water leakage.

Connect it to the branch drain pipe of the trough

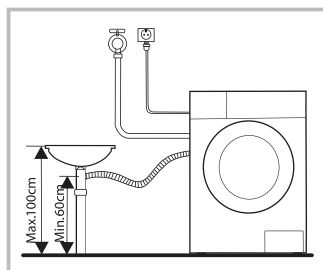

📌 Note!

- If the machine has drain hose support, please install it like the following.

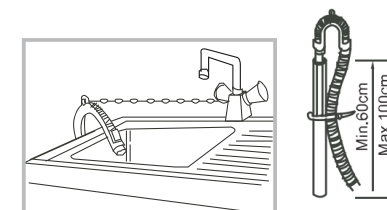

⚠ Warning!

- When installing drain hose, fix it properly with a rope.
- If drain hose is too long, do not force it into washing machine as it will cause abnormal noises.

GB

Operations

Quick Start

⚠ Caution!

- Before washing, please make sure it's installed properly.
- Before washing it first time, the washing machine shall be operated in one round of the whole procedures without clothes in as follows.

1. Before Washing

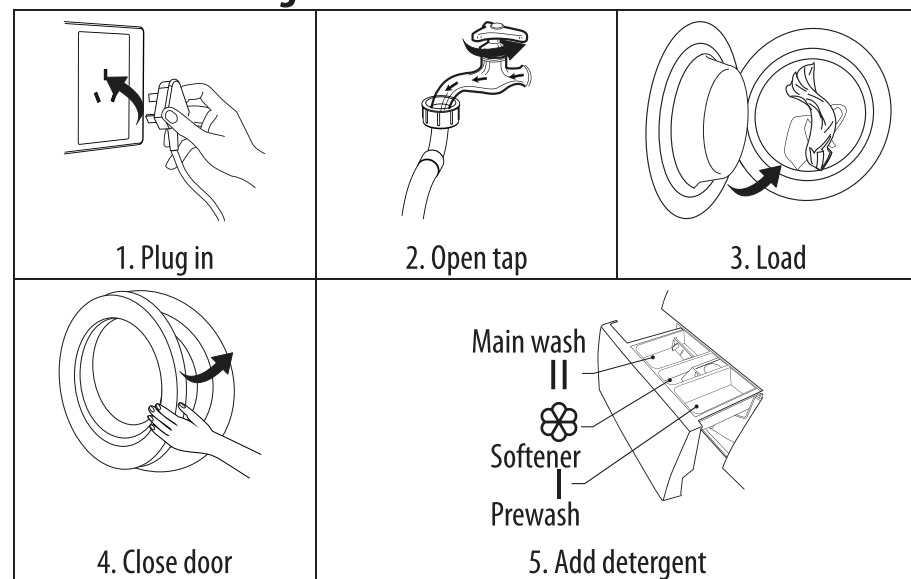

Note!

- Detergent only need to be added in "case I" after selecting pre-washing for machines with this function.

2. Washing

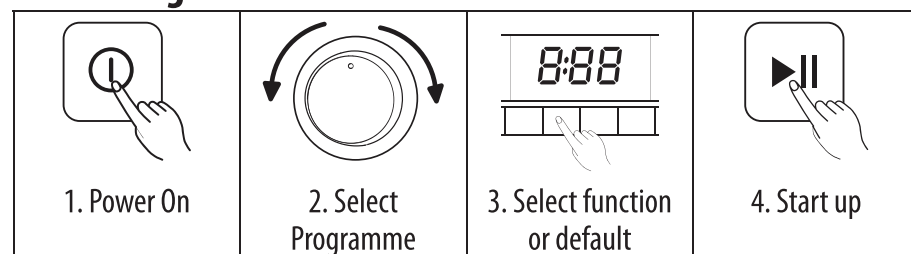

Note!

- If default is selected, step 3 can be skipped.

3. After Washing

Buzzer beep or "End" on display.

Before Each Washing

- The working condition of the washer should be (0-40) °C. If used under 0°C, the inlet valve and draining system may be damaged. If the machine is placed under condition of 0°C or less, then it should be transferred to normal ambient temperature to ensure the water supply hose and drain hose are not frozen before use.
- Please check the labels and the explanation of using detergent before wash. Use non-foaming or less-foaming detergent suitable for machine washing properly.

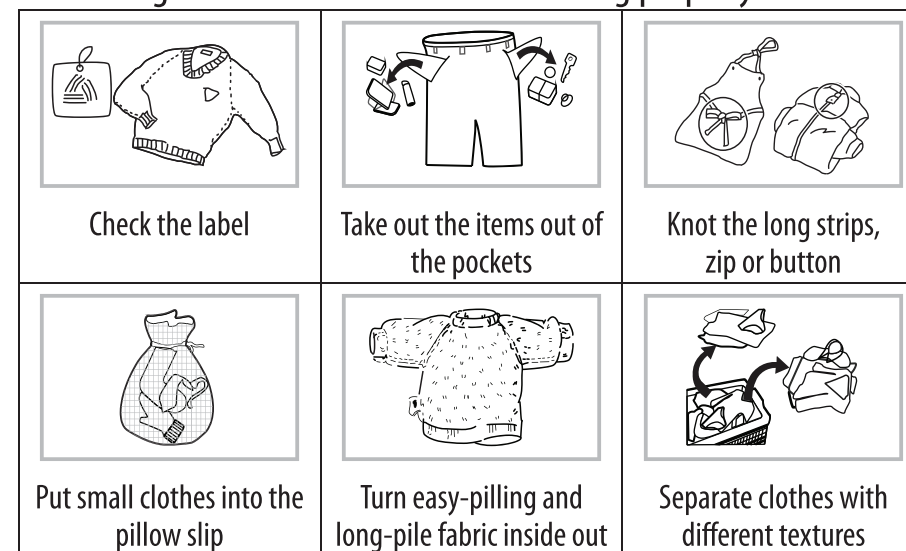

⚠ Warning!

- When washing a single clothes, it may easily cause great eccentricity and give alarm due to great unbalance. Therefore it is suggested to add one or two more clothes to be washed together so that draining can be done smoothly.

Detergent Dispenser

- I Pre wash detergent
- II Main wash detergent
- ☼ Softener

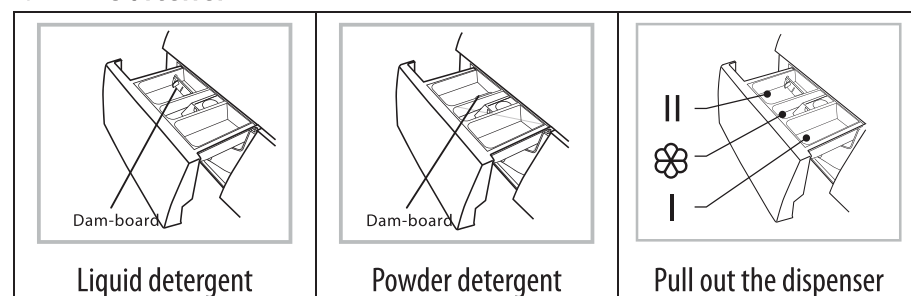

⚠ Caution!

- Detergent only need to be added in "case I" after selecting pre-washing for machines with this function.

Programme	I	II	☼
Coton intensif (Cotton Intensive)	○	●	○
Coton (Cotton) 60°C	○	●	○
Coton (Cotton) 40°C	○	●	○
Coton (Cotton) 20°C*	○	●	○

Rapide 15' (Quick 15')		●	○
Lavage Eco (ECO Wash)		●	○
Rinçage/Essorage (Rinse&Spin)			○
Essorage (Spin Only)			
Vidange (Drain Only)			
Laine (Wool)		●	○
Délicat (Delicate)		●	○
Mixte (Mix)	○	●	○
Synthétique (Synthetic)	○	●	○
Sport (Sport Wear)		●	○
Vêtement bébé (Baby Care)		●	○

- Means must
- Means optional

📌 Note!

- As for the agglomerated or ropy detergent or additive, before they are poured into the detergent box, it is suggested to use some water for dilution to prevent the inlet of detergent box from being blocked and overflowing while filling water.
- Please choose suitable type of detergent for the various washing temperature to get the best washing performance with less water and energy consumption.

Control Panel

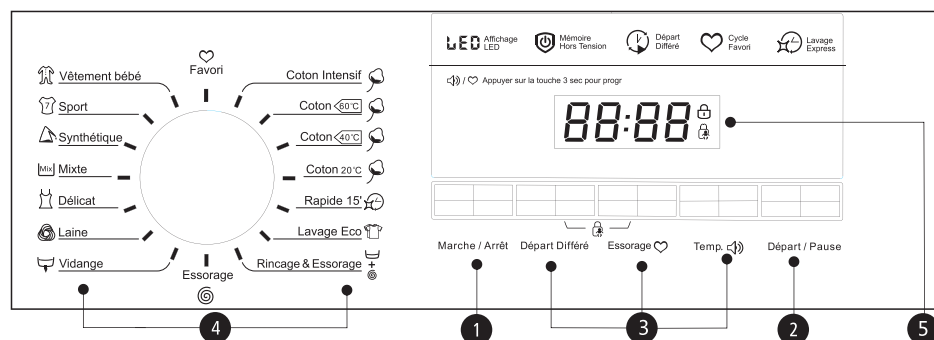

Note!

- The chart is for reference only, Please refer to real product as standard.

1 On/Off

Product is switched on or off.

3 Option

This allows you to select an additional function and will light when selected.

5 Display

The display shows the settings, estimated time remaining, options, and status messages for your washer. The display will remain on through the cycle.

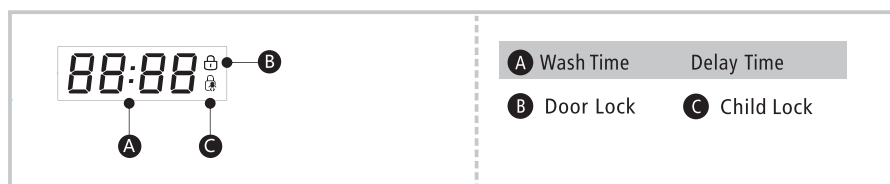

Option



Départ différé (Delay)

Set the Delay function:

1. Select a programme
2. Press the **Départ différé** (Delay) button to choose the time (the delaying time is 0-24 H.)
3. Press **Départ/Pause** (Start/Pause) to commence the delay operation

Marche/arrêt (On/Off) > Choose the Programme > (Setting time) > (Start) (⏻) > (Delay) > (▶||)

Cancel the Delay function:

Press the **Minuterie** (Delay) button until the display be 0H. It should be pressed before starting the programme. If the programme already started, should press the **Marche/arrêt** (On/Off) button to reset the programme.

! Caution!

- If there is any break in the power supply while the machine is operating, a special memory stores the selected programme and when the power is restarted, press the **Départ/Pause** (Start/Pause) button the program will continues.



(Child Lock)

To avoid mis operation by children.



Marche/arrêt (On/Off) > Start > Press **Départ Différé** (delay) and **Essorage** (spin) 3 sec. till buzzer beep.

⚠ Caution!

- Press the two button 3 sec. also to be released the function.
- The (Child Lock) will lock all buttons except **Marche/arrêt** (On/Off).
- If you stop the appliance, the child lock will be disabled.
- On some models, the (child lock) function remains active once the washing machine has been restarted after a power failure.



Favoris (My Cycle)

Memory the frequently used programmes
Press **Essorage** ♥ (Speed Wash) 3 sec. to memory the running programme. The default is cotton.

Temp.

Température (Temp.)

Press the button to regulate the temperature (Cold, 20°C, 30°C, 40°C, 60°C, 90°C)

Essorage

Essorage (Spin)

Press the button to change the spin speed. 0-400-800-1200-1400 tr/mn



Mute the buzzer

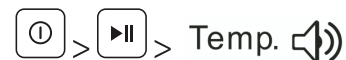

Marche/arrêt (On/Off) > Start > Just press 3 seconds on Temp. to cut off the buzzer.

To act the buzzer function, press the two buttons again for 3 seconds.

The setting will be kept until the next reset.

⚠ Caution!

- After Muting the buzzer function, the sounds will not be activated any more.

Programmes

Programmes are available according to the laundry type.

Programmes	
Cotton Intensive	To increase the washing effects, main additional washing time is increased. It is recommended to wash the clothes for babies or worn by the persons with allergic skin.
Synthetic	Wash synthetic articles, for example: shirts, coats, blending. While washing the knitting textiles, detergent quantity shall be reduced due to its loose string construction and easily forming bubbles.
Baby Care	Washing the baby's clothes, it can make the baby's wear cleaner and make the rinse performance better to protect the baby skin.
Mixed	Mixed load consisting of textiles made of cotton and synthetics.
Eco Wash	As for few light dirty clothes, the maximum temperature of washing is limited to 40°C, and saving more energy.
Sports	You can select this procedure to wash the activewear.
Quick 15'	This procedure is suitable for washing few and not very dirty clothes quickly.
Delicate	For delicate, washable textiles, e.g. made of silk, satin, synthetic fibres or blended fabrics.
Wool	Hand or machine-washable wool or richwool textiles. Especially gentle wash programme to prevent shrinkage, longer programme pauses (textiles rest in wash liquor).
Spin Only	Extra spin with selectable spin speed.
Rinse&Spin	Extra rinse with spin.
Drain Only	Drain off the water.

Washing Programmes Table

Model: LFS814MI18W

Programme	Load(kg)	Temp.(°C)	Default Time (H:mm)
Coton intensif (Cotton Intensive)	8	40	2:00
Coton (Cotton) <60°C	8	60	3:49
Coton (Cotton) <40°C	8	40	3:49
Coton (Cotton) 20°C*	8	20	1:22
Rapide 15' (Quick 15')	2	Froid	0:15
Lavage Eco (ECO Wash)	2	30	1:04
Rinçage/Essorage (Rinse&Spin)	8	Froid	0:35
Essorage (Spin Only)	8	/	0:13
Vidange (Drain Only)	/	/	0:01
Laine (Wool)	2	40	1:04
Délicat (Delicate)	2,5	30	1:10
Mixte (Mix)	8	40	1:19
Synthétique (Synthetic)	4	40	1:17
Sport (Sport Wear)	4	40	1:27
Vêtement bébé (Baby Care)	8	60	1:50

- The EU energy efficiency class is: A+++
Energy test program: Cotton ECO 60/40°C.
Speed: the highest speed; Other as the default.
Half load for 8.0 Kg machine: 4.0 Kg.
- "Cotton ECO 60/40°C" is the standard washing programs to which the information in the label and the fiche relates, and

they are suitable to clean normally soiled cotton laundry and that they are the most efficient programmes in terms of combined energy and water consumptions for washing that type of cotton laundry, that the actual water temperature may differ from the declared cycle temperature.

Note!

- The parameters in this table are only for user's reference. The actual parameters maybe different with the parameters in above mentioned table.

Maintenances

Cleaning and Care

Warning!

- Before your maintenance starts, please unplug the machine and close the tap.

Cleaning The Cabinet

Proper maintenance on the washing machine can extend its working life. The surface can be cleaned with diluted non-abrasive neutral detergents when necessary. If there is any water overflow, use the wet cloth to wipe it off immediately.
No sharp items are allowed.

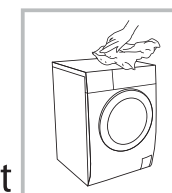

Note!

- Formic acid and its diluted solvents or equivalent are forbidden, such as alcohol, solvents or chemical products, etc.

Cleaning The Drum

The rusts left inside the drum by the metal articles shall be removed immediately with chlorine-free detergents. Never use steel wool.

Note!

- Don't put laundry in the washing machine during the drum cleaning.

Cleaning The Door Seal And Glass

Wipe the glass and seal after each wash to remove lint and stains. If lint builds up it can cause leaks.

Remove any coins, buttons and other objects from the seal after each wash.

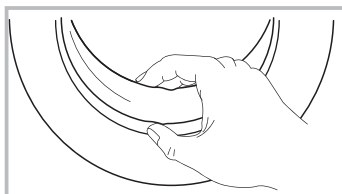

Cleaning The Inlet Filter

Note!

- Inlet filter must be cleaned if there is less water.

Washing the filter in the tap

- Close the tap.
- Remove the water supply hose from the tap.
- Clean the filter.

- Reconnect the water supply hose.

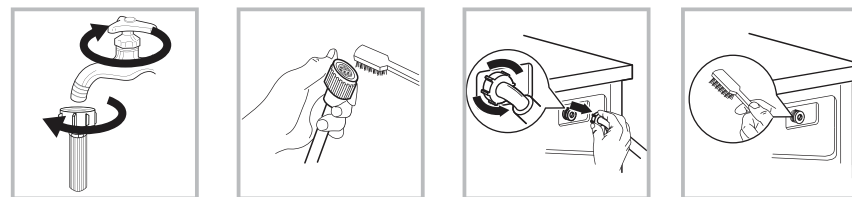

Washing the filter in washing machine:

- Screw off the inlet pipe from the backside of the machine.
- Pull out the filter with long nose pliers and reinstall it back after being washed.
- Use the brush to clean the filter.
- Reconnect the inlet pipe.

Note!

- If the brush is not clean, you can pull out the filter washed separately;
- Reconnect, turn on the tap.

Clean The Detergent Dispenser

- Press down the arrow location on softener cover inside the dispenser drawer.
- Lift the clip up and take out softener cover and wash all grooves with water.
- Restore the softener cover and push the drawer into position.

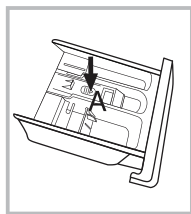

1. Pull out the dispenser drawer with press the A

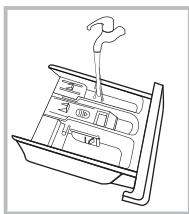

2. Clean the dispenser drawer under water

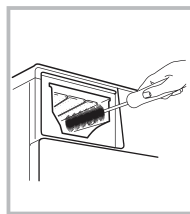

3. Clean inside the recess with an old toothbrush

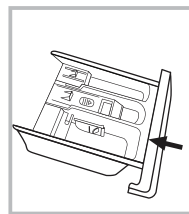

4. Insert the dispenser drawer

Note!

- Do not use alcohol, solvents or chemical products to clean the machine.

Cleaning The Drain Pump Filter

Warning!

- Be careful of the hot water!
- Allow detergent solution to cool down.
- Unplug the machine to avoid electrical shock before washing.
- Drain pump filter can filter the yarns and small foreign matters from the washing.
- Clean the filter periodically to ensure the normal operation of washing machine.

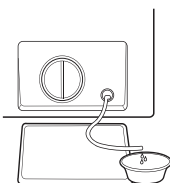
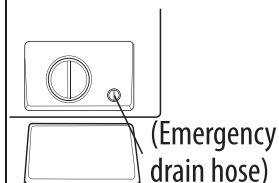
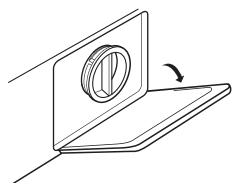

1. Open the lower cover cap



4. Open the filter by turning to the counter clockwise

2. Rotate 90°C and pull out the emergency drain hose, and take off the hose cap

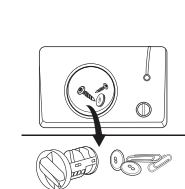

5. Remove extraneous matter

3. After water runs out, reset the drain hose

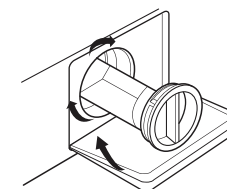

6. Close the lower cover cap

Caution!

- Make sure that valve cap and emergency drain hose are reinstalled properly, cap plates should be inserted aligning to hole plates otherwise water may leak.
- Some machines don't have emergency drain hose, so step 2 and step 3 can be skipped. Rotate lower cover cap directly to make water run into basin.
- When the appliance is in use and depending on the programme selected there can be hot water in the pump. Never remove the pump cover during a wash cycle, always wait until the appliance has finished the cycle, and is empty. When replacing the cover, ensure it is securely re-tightened.

Trouble shooting

The start of the appliance does not work or it stops during operation.

First try to find a solution to the problem, If not, contact the service centre.

Description	Reason	Solution
Washing machine cannot start up	Door is not closed properly	Restart after the door is closed Check if the clothes is stuck
Door can't be opened	Washer's safety protection design is working	Disconnect the power, restart the product
Water leakage	The connection between inlet pipe or outlet hose is not tight	Check and fasten water pipes Clean up outlet hose
Detergent residues in the box	Detergent is dampened or agglomerated	Clean and wipe the detergent box
Indicator or display does not light	Disconnect the power PC board or harness has connection problem	Check if the power is shut down and the power plug is connected correctly
Abnormal noise		Check if the fixing (bolts) have been removed Check it's installed on a solid and level floor
Description	Reason	Solution
E30	Door is not closed properly	Restart after the door is closed Check if the clothes is stuck

GB

E10	Water injecting problem while washing	Check if the water pressure is too low Straighten the water pipe Check if the inlet valve filter is blocked
E21	Overtime water draining	Check if the drain hose is blocked
E12	Water overflow	Restart the washer
EXX	Others	Please try again first, call up service line if there are still troubles

Note!

- After the check, activate the appliance. If the problem occurs or the display alarm codes again, contact the service.

Technical Specifications

Power Supply	220-240V/50Hz
MAX.Current	10A
Standard Water Pressure	0.05MPa~1MPa

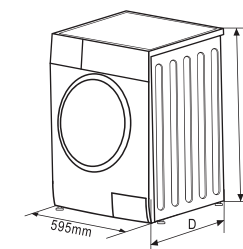

Model	Washing Capacity	Dimension (W*D*H mm)	Net Weight	Rated Power
LFS814MI18W	8,0kg	595*565*850	68 kg	2000W

GB

Technical Information

Marque	SABA
Modèle	LFS814MI18W
Code produit	653604
Capacité nominale du coton	8.0kg
Classe d'efficacité énergétique	A +++
Consommation d'énergie annuelle *1)	196kWh/an
Consommation d'énergie programme coton standard 60°C à pleine charge	0.97kwh/cycle
Consommation d'énergie programme coton standard 60°C à demi-charge	0.75kwh/cycle
Consommation d'énergie programme coton standard 40°C à demi-charge	0.72kwh/cycle
Consommation électrique en mode arrêt/laissé sur marche	0.5W /1.0W
Consommation d'eau annuelle *2)	11000L
Consommation d'eau pour le programme «coton» standard à 60°C à pleine charge Wt,60	54L/cycle
Consommation d'eau pour le programme «coton» standard à 60°C à demi-charge Wt,60½	45L/cycle
Consommation d'eau pour le programme «coton» standard à 40°C à demi-charge Wt,40½	45L/cycle
Classe énergétique d'essorage *3)	B
Vitesse d'essorage max/taux d'humidité résiduelle	1400rpm/55%
Programme ECO standard *4)	Coton ECO
Durée du programme coton standard à 60 °C à pleine charge	232min
Durée du programme coton standard à 60 °C à demi-charge	215min
Durée du programme coton standard à 40 °C à demi- charge	214min
Durée du mode laissé sur marche	1 min
Emissions acoustiques dans l'air en lavage / essorage *5)	58/78dB(A) re 1 pw
Mode d'installation	Pose libre
<p>*1) sur la base de 220 cycles de lavage standard par an pour les programmes coton à 60 °C et à 40 °C à pleine charge et à demi-charge, et de la consommation des modes à faible puissance. La consommation réelle d'énergie dépend des conditions d'utilisation de l'appareil.</p> <p>*2) sur la base de 220 cycles de lavage standard par an pour les programmes coton à 60 °C et à 40 °C à pleine charge et à demi-charge.</p> <p>La consommation réelle d'eau dépend des conditions d'utilisation de l'appareil.</p> <p>*3) sur une échelle allant de G (appareils les moins efficaces) à A (appareils les plus efficaces).</p> <p>*4) Programme le plus efficace en terme de consommation combinée d'énergie et d'eau pour laver du linge coton normalement sale.</p> <p>*5) pour le programme «coton» standard à 60°C à pleine charge.</p>	

GB

Note!

- Programme setting for testing in accordance with applicable standard En60456.
- When using the test programmes, wash the specified load using the maximum spin speed.
- The actual parameters will depend on how the appliance is used, and maybe different with the parameters in above mentioned table.
- The household washing machine is equipped with power management system. The duration of the left-on mode time is less than 1 minute.
- The noise emissions during washing/spinning for the standard washing cycle at full load.

GB

Disposal of old electrical appliances



The European directive 2012/19/EU on Waste Electrical and Electronic Equipment (WEEE), requires that old household electrical appliances must not be disposed of in the normal unsorted municipal waste stream. Old appliances must be collected separately in order to optimize the recovery and recycling of the materials they contain, and reduce the impact on human health and the environment.

GB

The crossed out “wheeled bin” symbol on the product reminds you of your obligation, that when you dispose of the appliance, it must be separately collected.

Consumers should contact their local authority or retailer for information concerning the correct disposal of their old appliance.

